



**PARALU FILEA B30** is a non thermal window and door sliding system of high-performance , suitable for high-rise buildings and extreme weather conditions.

Paralu Filea B30 is designed to meet the highest European quality standards and comply with international air-tightness, water resistance, and wind resistance regulations.

Main advantages :

- Sliding doors hidden in the walls.
- A separate cover joint can be added.
- A separate fly screen rail can be added.
- Integrated water condensation channel
- Handle with multi-point locking system

## ARCHITECTURAL ASPECT

Visible Height	Frame (side)	38mm
	Frame (Top and bottom)	35mm
	Panel (side)	63mm
	Panel (Top and bottom)	59mm
Glass Thickness		6 to 30mm

## DIMENSIONS AND WEIGHTS

Width Per Leaf	Min	700mm
	Max	1500mm
Height Per Leaf	Min	1000mm
	Max	3000mm
Weight Per Leaf	Max	150kg

The curves in the table below correspond to a 2-leaf frame, for frames with more than 2 leaves, use a width of 2 leaves

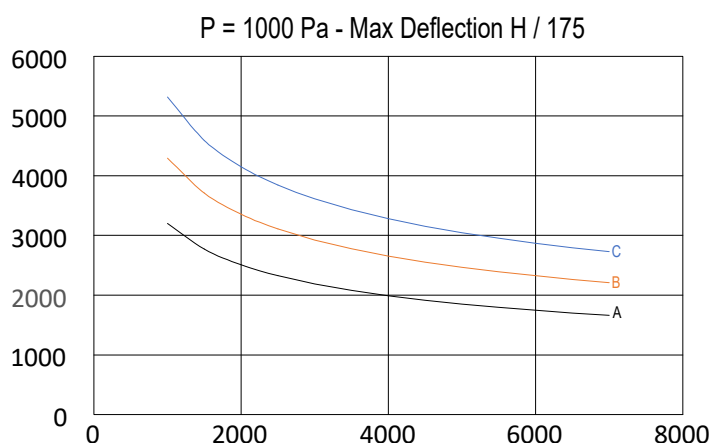
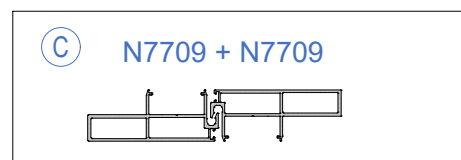
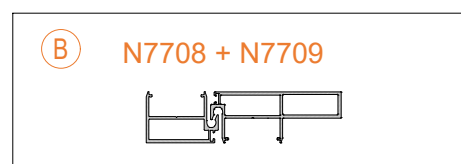
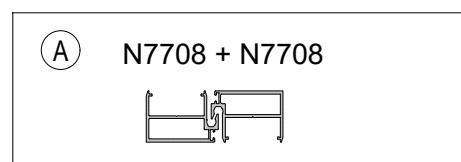

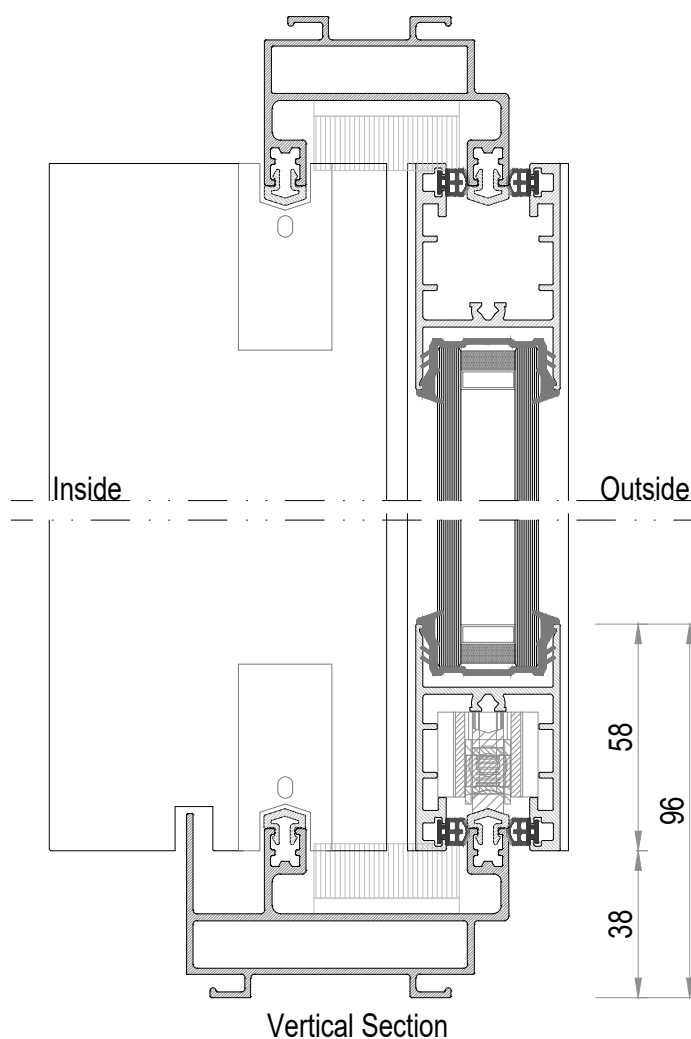
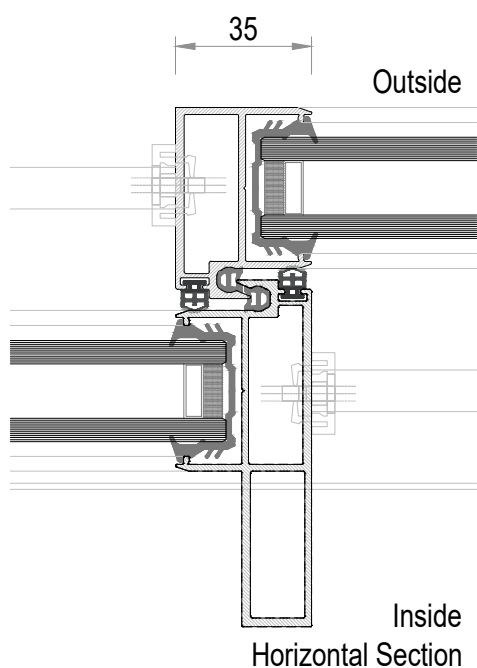
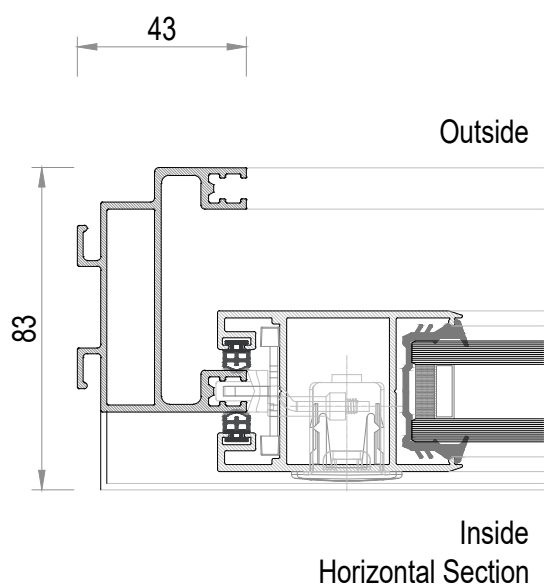

## PERFORMANCE

Acoustical Performance	Rw = 48 DB
Air Permeability	(EN 12207) : Classe A*4
Burglary	WK2 (Dutch & European standard NEN 5096 & ENV1627)
Thermal Performance	RW(C;Ctr) ≤ 48 (-1;-3)dB depending on type of glass
Water Permeability	(EN 12208) : Classe E*6B
Wind Resistance	(EN 12210) : Classe V*B3